

ASSEMBLY INSTRUCTION

Lifestyle

FURNITURE

www.lifestylefurniture.co.uk

0 MINS

APPROXIMATE ASSEMBLY TIME



2 PERSON ASSEMBLY

FLOOR AREA
2Mx2.5M

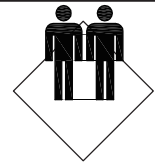

REQUIRED ASSEMBLY SPACE

REQUIRED ASSEMBLY TOOLS

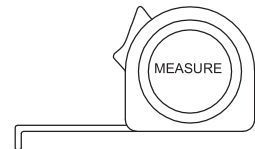

ASSEMBLED DIMENSIONS

W80*D45*H75CM

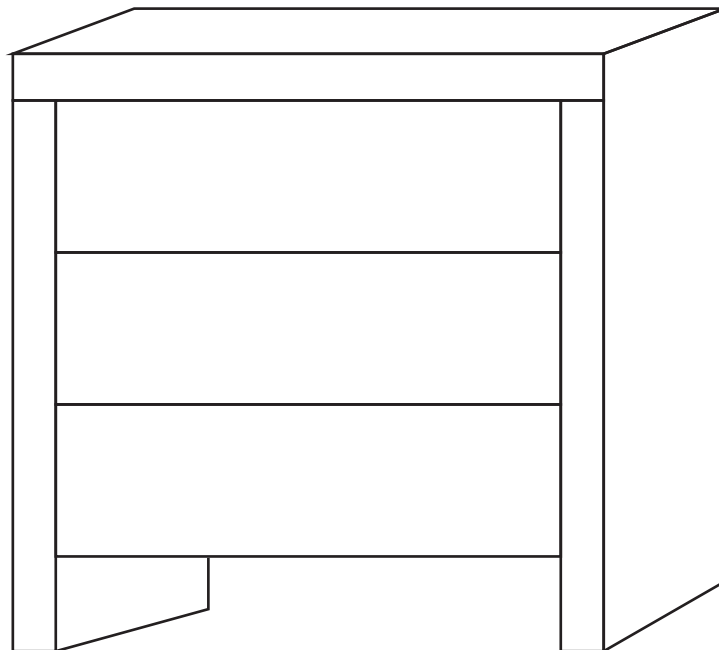

MALMO 3 DRAWER WIDE CHEST

Care and Maintenance of your Furniture

- Please periodically check all fittings and re-tighten as necessary.
- Please do not drag or pull your furniture.
- Wipe occasionally with a soft cloth slightly dampened with water. Then buff with a dry clean soft cloth.
- Never allow any kind of liquid to remain on your furniture. Absorption can cause wood to warp or finishes to de-laminate.
- If the glass is chipped or broken, stop using the product and consult the supplier.
- Please do not place very hot or very cold items on the glass surface, unless adequately thick table mats are used to prevent such items from coming into contact with the glass.
- Please do not use glass as chopping surface. Do not strike the glass with hard or pointed items.
- When cleaning glass panels use a damp cloth with washing up liquid or soft soap if necessary.
- Do not use washing powders or any other substances containing abrasives since these substances scratch glass panel.

FITTING OF ANTI-TIP STRAP

STEP 1:

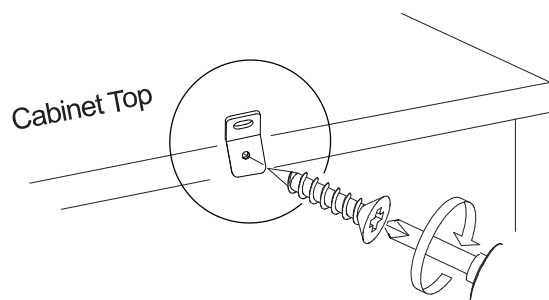

STEP 2:

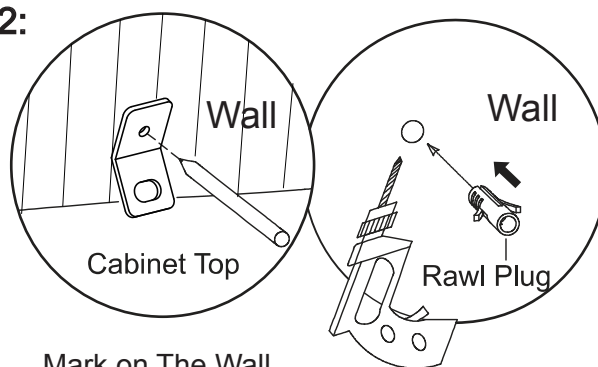

Drill a hole in the wall and insert the rawl plug.

STEP 3:

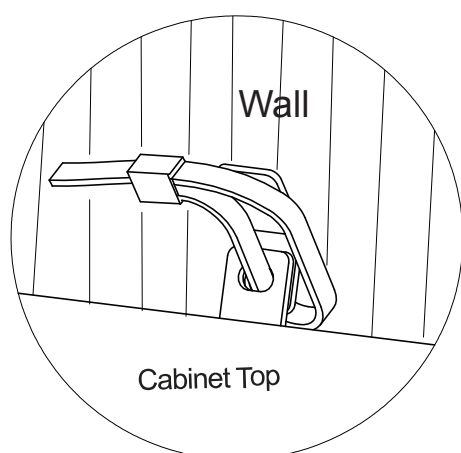

HARDWARE LIST



Anti-Tip Strap



The screw supplied is to fix the Strap to the cabinet.

Note: Wall fixings are not supplied with this product as different wall materials require different types of fixing devices (such as Rawl plugs on brick work). You must use fixing devices suitable for the type of wall you intend to mount this products to.

please ensure that the head of any screw used has diameter greater than the diameter of the mounting hole on the bracket and that the fixing is safe and secure before use.

The screw supplied is to fix the bracket to the cabinet.

Wall Types :

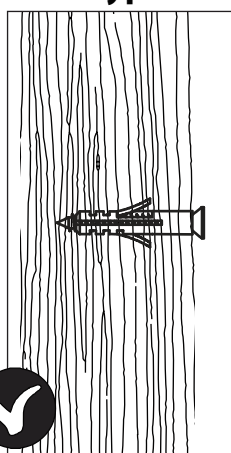

Wood
(Can use rawl plug as shown)
(Can use rawl plug)

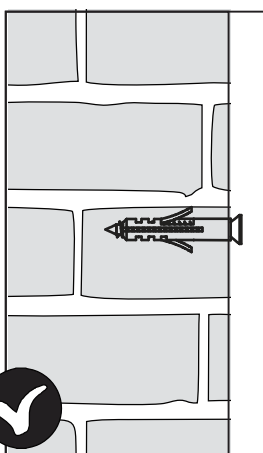

Brick & Masonry
(Can use rawl plug as shown)

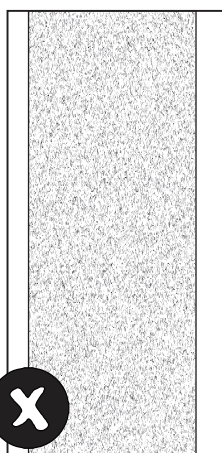

Chipboard
(Can't use any type of wall plugs)

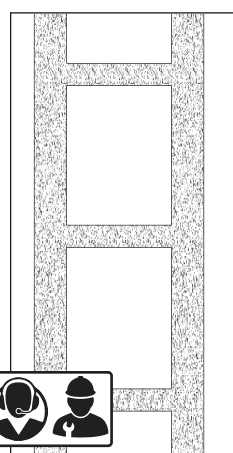

Cavity Wall
(Special toggle wall plugs are needed, Seek expert advice)

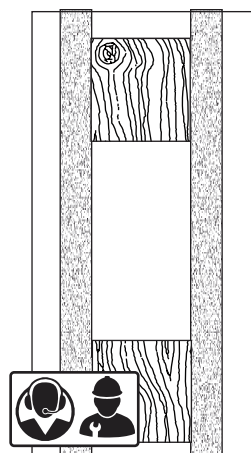

Stud Partition/Plaster
(Special toggle wall plugs are needed, Seek expert advice)

MALMO 3 DRAWER WIDE CHEST